

4007 DOVERCREST DRIVE SE, CALGARY, AB

MAIN - 941.23 Sq.ft. / 87.44 m2

RMS TOTAL - 941.23 Sq.ft. / 87.44 m2

BASEMENT - 890.91 Sq.ft. / 82.77 m2

*FINISHED TOTAL - 745.65 Sq.ft. / 69.27 m2

DETACHED SINGLE FAMILY

*RECA RMS MEASUREMENTS ARE TAKEN TO EXTERIOR FOUNDATION

TEAM PENLEY MCNAUGHTON
RE/MAX REAL ESTATE (CENTRAL)
1:00 | JULY 4, 2019

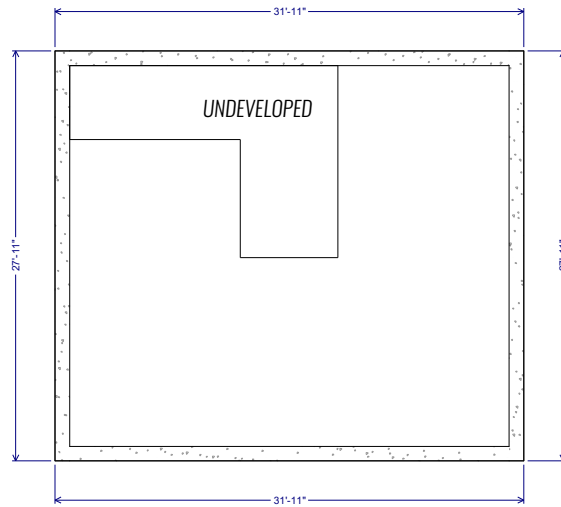

BASEMENT

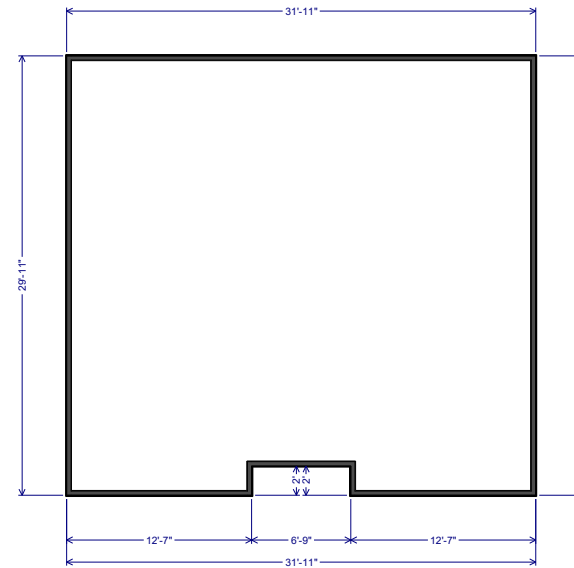

MAIN LEVEL